

ROUTINE MAPS FOR INSPECTION GROUPS

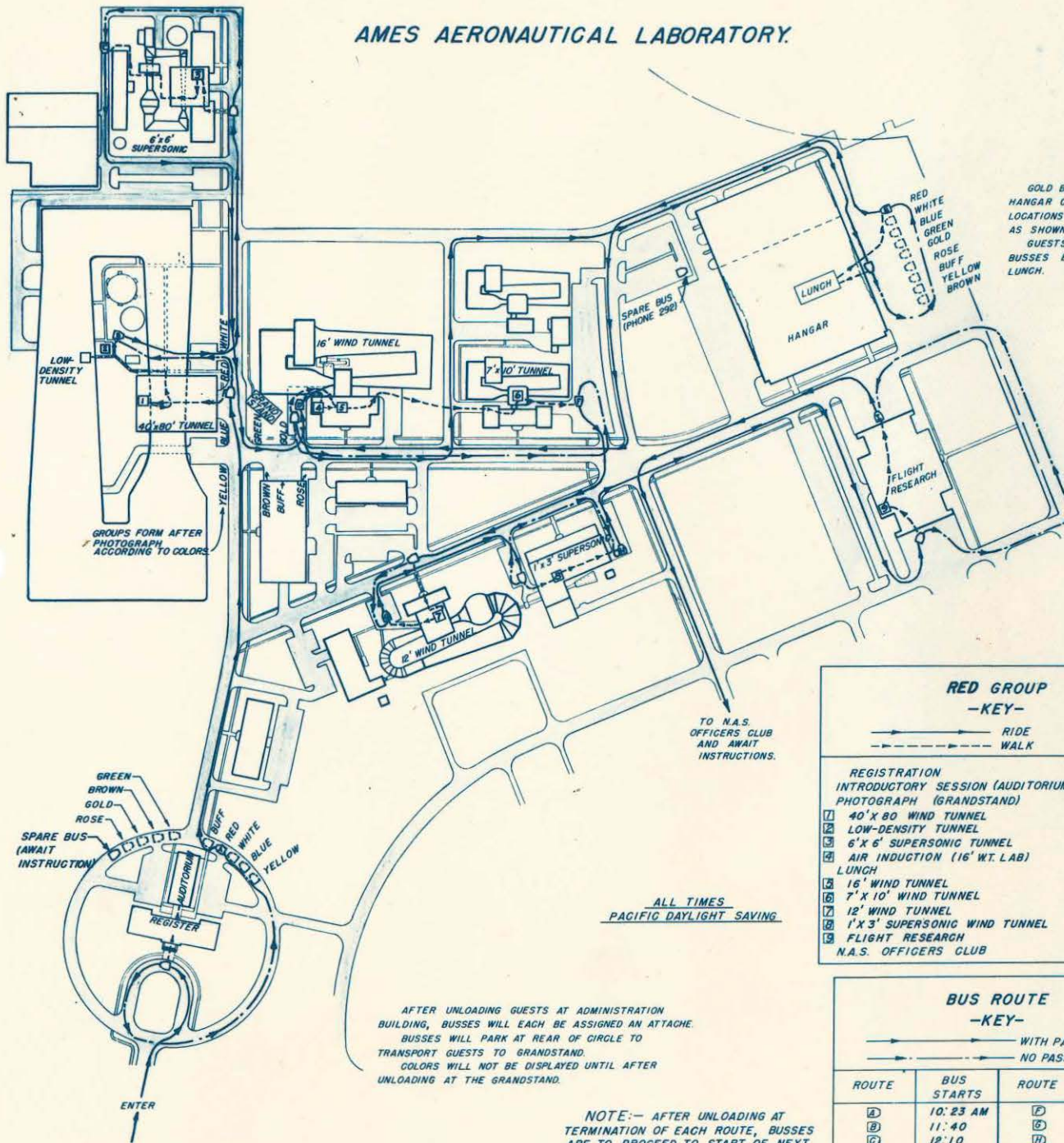

1948 INSPECTION

AMES AERONAUTICAL LABORATORY



GOLD BUS PARKED OPPOSITE HANGAR CENTER. RELATIVE LOCATIONS OF OTHER BUSES AS SHOWN. GUESTS TO BE ABOARD BUSES BY 2:05 P.M. AFTER LUNCH.

TO N.A.S. OFFICERS CLUB AND AWAIT INSTRUCTIONS.

ALL TIMES PACIFIC DAYLIGHT SAVING.

AFTER UNLOADING GUESTS AT ADMINISTRATION BUILDING, BUSES WILL EACH BE ASSIGNED AN ATTACHE. BUSES WILL PARK AT REAR OF CIRCLE TO TRANSPORT GUESTS TO GRANDSTAND. COLORS WILL NOT BE DISPLAYED UNTIL AFTER UNLOADING AT THE GRANDSTAND.

NOTE:— AFTER UNLOADING AT TERMINATION OF EACH ROUTE, BUSES ARE TO PROCEED TO START OF NEXT ROUTE AND AWAIT NEXT TIME OF DEPARTURE.

**RED GROUP -KEY-**

|                                   | EVENT STARTS |
|-----------------------------------|--------------|
| REGISTRATION                      | 9:30 AM      |
| INTRODUCTORY SESSION (AUDITORIUM) | 10:00        |
| PHOTOGRAPH (GRANDSTAND)           | 10:32        |
| ① 40'x80' WIND TUNNEL             | 10:45        |
| ② LOW-DENSITY TUNNEL              | 11:15        |
| ③ 6'x6' SUPERSONIC TUNNEL         | 11:45        |
| ④ AIR INDUCTION (16' WT. LAB)     | 12:15 P.M.   |
| LUNCH                             |              |
| ⑤ 16' WIND TUNNEL                 | 2:15         |
| ⑥ 7'x10' WIND TUNNEL              | 2:45         |
| ⑦ 12' WIND TUNNEL                 | 3:15         |
| ⑧ 1'x3' SUPERSONIC WIND TUNNEL    | 3:45         |
| ⑨ FLIGHT RESEARCH                 | 4:15         |
| N.A.S. OFFICERS CLUB              | 4:45         |

**BUS ROUTE -KEY-**

| ROUTE | BUS STARTS | ROUTE | BUS STARTS |
|-------|------------|-------|------------|
| A     | 10:23 AM   | D     | 3:10       |
| B     | 11:40      | E     | 3:40       |
| C     | 12:10      | F     | 4:10       |
| D     | 12:40      | G     | 4:40       |
| E     | 2:10 PM    |       |            |





1948 INSPECTION

AMES AERONAUTICAL LABORATORY

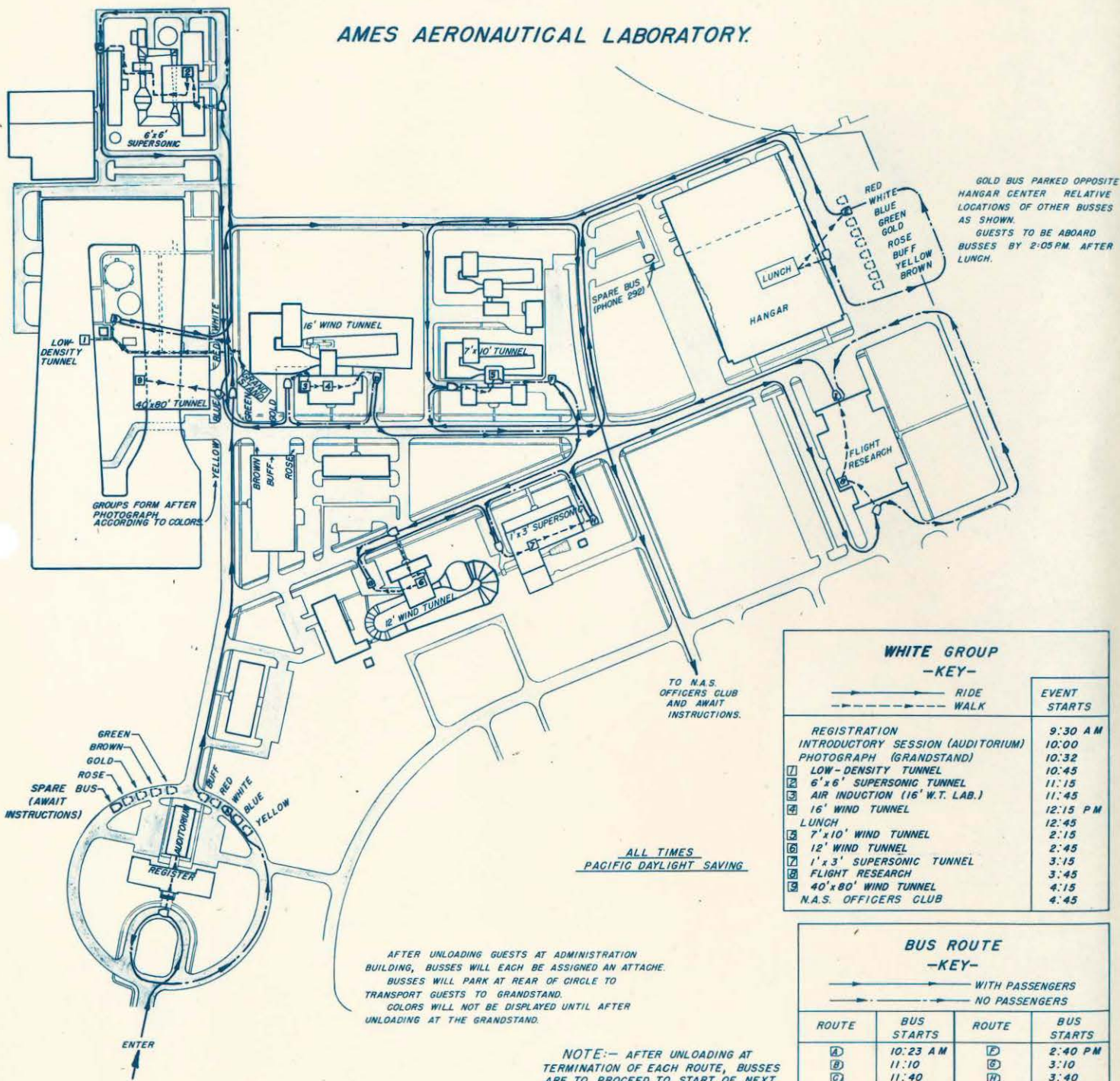

GOLD BUS PARKED OPPOSITE HANGAR CENTER RELATIVE LOCATIONS OF OTHER BUSES AS SHOWN.  
GUESTS TO BE ABOARD BUSES BY 2:05 PM. AFTER LUNCH.

TO N.A.S. OFFICERS CLUB AND AWAIT INSTRUCTIONS.

ALL TIMES PACIFIC DAYLIGHT SAVING

AFTER UNLOADING GUESTS AT ADMINISTRATION BUILDING, BUSES WILL EACH BE ASSIGNED AN ATTACHE. BUSES WILL PARK AT REAR OF CIRCLE TO TRANSPORT GUESTS TO GRANDSTAND. COLORS WILL NOT BE DISPLAYED UNTIL AFTER UNLOADING AT THE GRANDSTAND.

WHITE GROUP

-KEY-

→ RIDE  
- - - WALK

|                                   | EVENT STARTS |
|-----------------------------------|--------------|
| REGISTRATION                      | 9:30 AM      |
| INTRODUCTORY SESSION (AUDITORIUM) | 10:00        |
| PHOTOGRAPH (GRANDSTAND)           | 10:32        |
| 1 LOW-DENSITY TUNNEL              | 10:45        |
| 2 6'x6' SUPERSONIC TUNNEL         | 11:15        |
| 3 AIR INDUCTION (16' W.T. LAB.)   | 11:45        |
| 4 16' WIND TUNNEL                 | 12:15 PM     |
| LUNCH                             | 12:45        |
| 5 7'x10' WIND TUNNEL              | 2:15         |
| 6 12' WIND TUNNEL                 | 2:45         |
| 7 1'x3' SUPERSONIC TUNNEL         | 3:15         |
| 8 FLIGHT RESEARCH                 | 3:45         |
| 9 40'x80' WIND TUNNEL             | 4:15         |
| N.A.S. OFFICERS CLUB              | 4:45         |

BUS ROUTE

-KEY-

→ WITH PASSENGERS  
- - - NO PASSENGERS

| ROUTE | BUS STARTS | ROUTE | BUS STARTS |
|-------|------------|-------|------------|
| A     | 10:23 AM   | D     | 2:40 PM    |
| B     | 11:10      | E     | 3:10       |
| C     | 11:40      | F     | 3:40       |
| D     | 12:40 PM   | G     | 4:10       |
| E     | 2:10       | H     | 4:40       |

NOTE:- AFTER UNLOADING AT TERMINATION OF EACH ROUTE, BUSES ARE TO PROCEED TO START OF NEXT ROUTE AND AWAIT NEXT TIME OF DEPARTURE.





1948 INSPECTION

AMES AERONAUTICAL LABORATORY

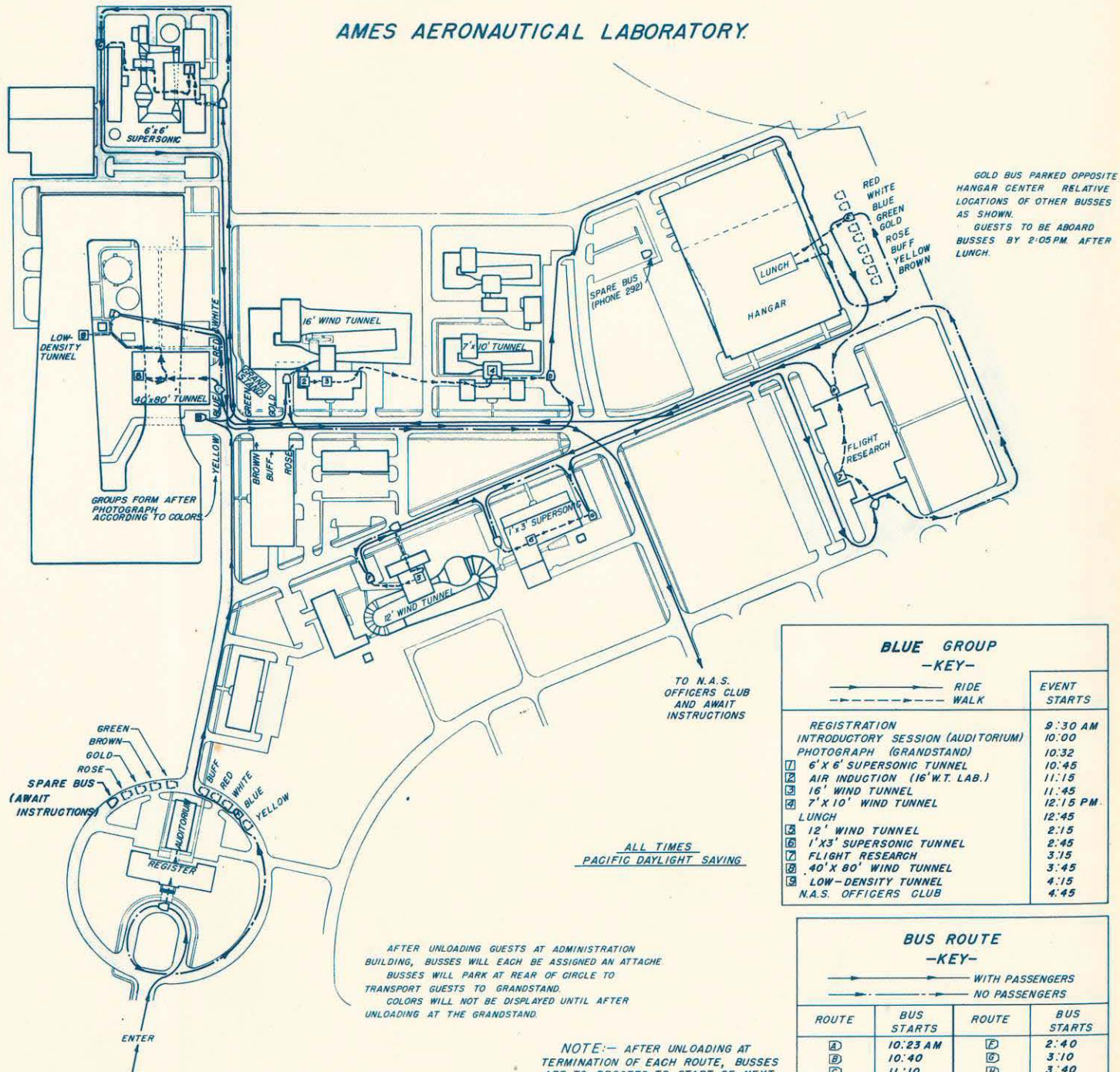

GOLD BUS PARKED OPPOSITE HANGAR CENTER. RELATIVE LOCATIONS OF OTHER BUSES AS SHOWN. GUESTS TO BE ABOARD BUSES BY 2:05 PM. AFTER LUNCH.

**BLUE GROUP -KEY-**

|                                   | EVENT STARTS |
|-----------------------------------|--------------|
| REGISTRATION                      | 9:30 AM      |
| INTRODUCTORY SESSION (AUDITORIUM) | 10:00        |
| PHOTOGRAPH (GRANDSTAND)           | 10:32        |
| 1 6' X 6' SUPERSONIC TUNNEL       | 10:45        |
| 2 AIR INDUCTION (16' W.T. LAB.)   | 11:15        |
| 3 16' WIND TUNNEL                 | 11:45        |
| 4 7' X 10' WIND TUNNEL            | 12:15 PM.    |
| LUNCH                             | 12:45        |
| 5 12' WIND TUNNEL                 | 2:15         |
| 6 1' X 3' SUPERSONIC TUNNEL       | 2:45         |
| 7 FLIGHT RESEARCH                 | 3:15         |
| 8 40' X 80' WIND TUNNEL           | 3:45         |
| 9 LOW-DENSITY TUNNEL              | 4:15         |
| N.A.S. OFFICERS CLUB              | 4:45         |

**BUS ROUTE -KEY-**

| ROUTE | BUS STARTS | ROUTE | BUS STARTS |
|-------|------------|-------|------------|
| A     | 10:23 AM   | D     | 2:40       |
| B     | 10:40      | E     | 3:10       |
| C     | 11:10      | F     | 3:40       |
| D     | 12:40 PM   | G     | 4:40       |
| E     | 2:10       |       |            |

AFTER UNLOADING GUESTS AT ADMINISTRATION BUILDING, BUSES WILL EACH BE ASSIGNED AN ATTACHE. BUSES WILL PARK AT REAR OF CIRCLE TO TRANSPORT GUESTS TO GRANDSTAND. COLORS WILL NOT BE DISPLAYED UNTIL AFTER UNLOADING AT THE GRANDSTAND.

NOTE:- AFTER UNLOADING AT TERMINATION OF EACH ROUTE, BUSES ARE TO PROCEED TO START OF NEXT ROUTE AND AWAIT NEXT TIME OF DEPARTURE.

ALL TIMES PACIFIC DAYLIGHT SAVING

TO N.A.S. OFFICERS CLUB AND AWAIT INSTRUCTIONS

GROUPS FORM AFTER PHOTOGRAPH ACCORDING TO COLORS

GREEN BROWN GOLD ROSE SPARE BUS (AWAIT INSTRUCTIONS) BUFF RED WHITE BLUE YELLOW

ENTER





1948 INSPECTION

AMES AERONAUTICAL LABORATORY

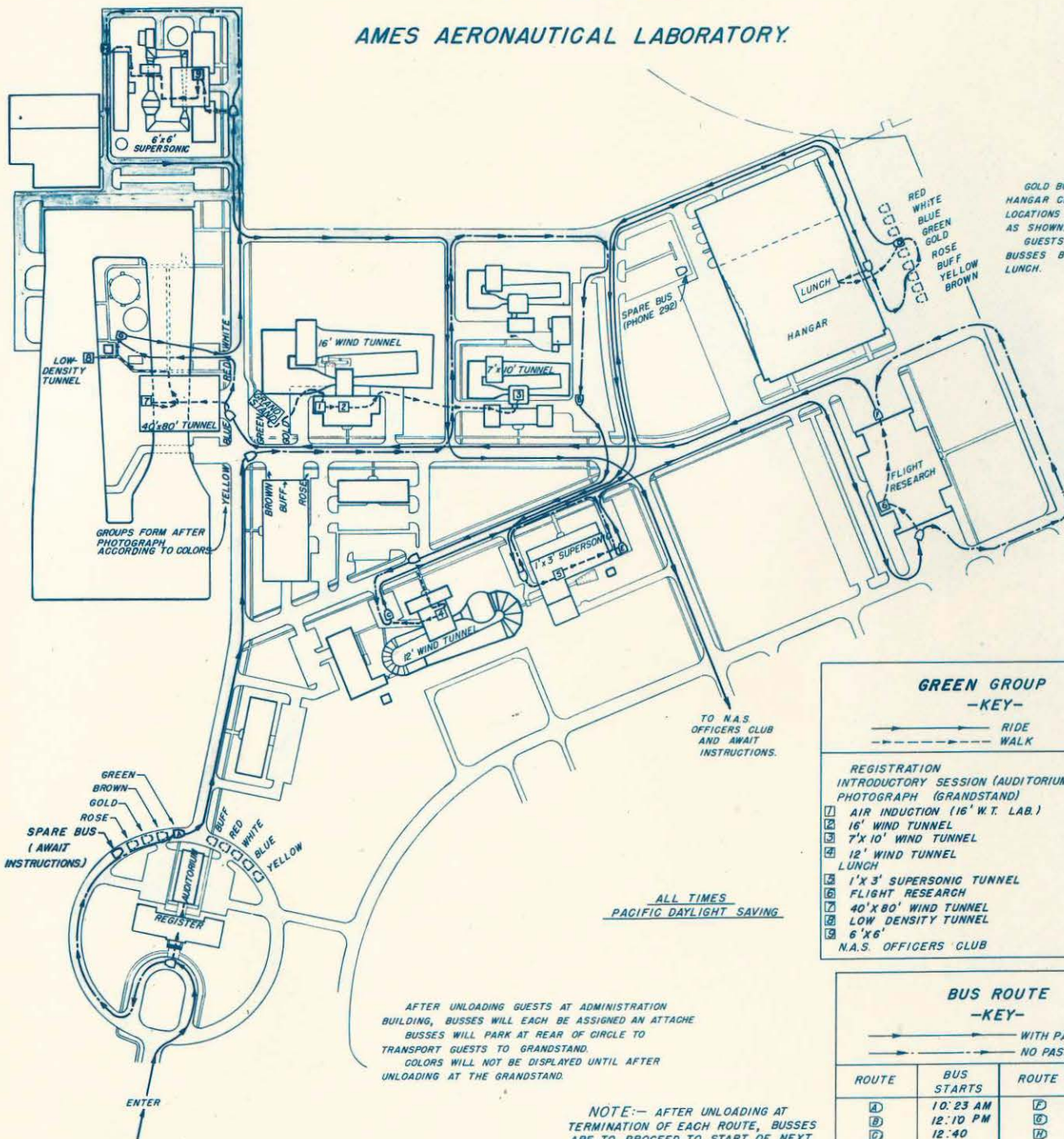

GOLD BUS PARKED OPPOSITE HANGAR CENTER. RELATIVE LOCATIONS OF OTHER BUSES AS SHOWN. GUESTS TO BE ABOARD BUSES BY 2:05 PM AFTER LUNCH.

TO N.A.S. OFFICERS CLUB AND AWAIT INSTRUCTIONS.

ALL TIMES PACIFIC DAYLIGHT SAVING

AFTER UNLOADING GUESTS AT ADMINISTRATION BUILDING, BUSES WILL EACH BE ASSIGNED AN ATTACHE. BUSES WILL PARK AT REAR OF CIRCLE TO TRANSPORT GUESTS TO GRANDSTAND. COLORS WILL NOT BE DISPLAYED UNTIL AFTER UNLOADING AT THE GRANDSTAND.

NOTE:-- AFTER UNLOADING AT TERMINATION OF EACH ROUTE, BUSES ARE TO PROCEED TO START OF NEXT ROUTE AND AWAIT NEXT TIME OF DEPARTURE.

**GREEN GROUP -KEY-**

|                                   | EVENT STARTS |
|-----------------------------------|--------------|
| REGISTRATION                      | 9:30 AM      |
| INTRODUCTORY SESSION (AUDITORIUM) | 10:00        |
| PHOTOGRAPH (GRANDSTAND)           | 10:32        |
| 1 AIR INDUCTION (16' W.T. LAB.)   | 10:45        |
| 2 16' WIND TUNNEL                 | 11:15        |
| 3 7'x10' WIND TUNNEL              | 11:45        |
| 4 12' WIND TUNNEL                 | 12:15 PM     |
| LUNCH                             | 12:45        |
| 5 1'x3' SUPERSONIC TUNNEL         | 2:15         |
| 6 FLIGHT RESEARCH                 | 2:45         |
| 7 40'x80' WIND TUNNEL             | 3:15         |
| 8 LOW DENSITY TUNNEL              | 3:45         |
| 9 6'x6'                           | 4:15         |
| N.A.S. OFFICERS CLUB              | 4:45         |

**BUS ROUTE -KEY-**

| WITH PASSENGERS |            | NO PASSENGERS |            |
|-----------------|------------|---------------|------------|
| ROUTE           | BUS STARTS | ROUTE         | BUS STARTS |
| A               | 10:23 AM   | D             | 3:10       |
| B               | 12:10 PM   | E             | 4:10       |
| C               | 12:40      | D             | 4:40       |
| D               | 2:10       |               |            |
| E               | 2:40       |               |            |





1948 INSPECTION  
AMES AERONAUTICAL LABORATORY.

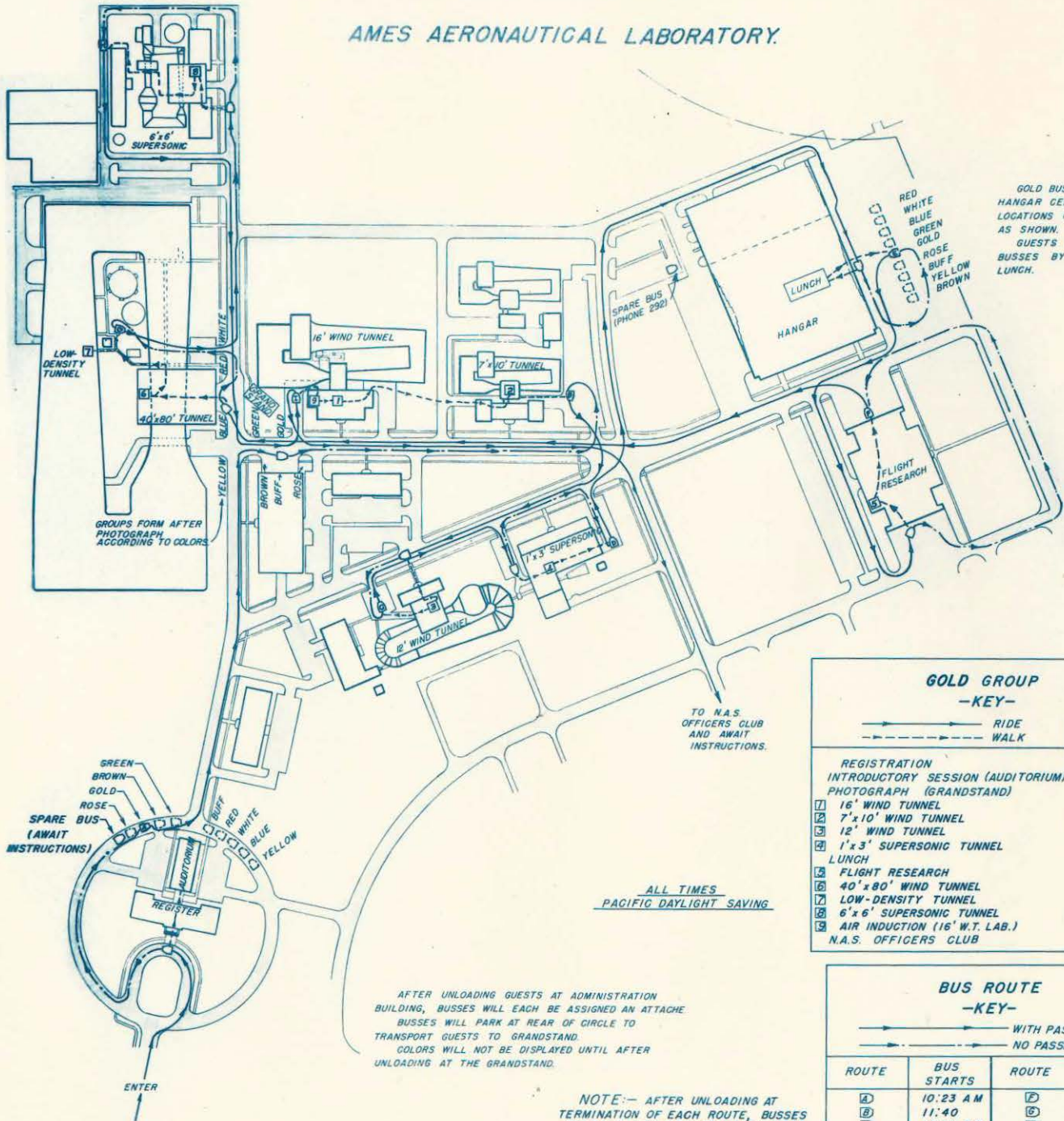

GOLD BUS PARKED OPPOSITE HANGAR CENTER. RELATIVE LOCATIONS OF OTHER BUSES AS SHOWN. GUESTS TO BE ABOARD BUSES BY 2:05 PM AFTER LUNCH.

TO N.A.S. OFFICERS CLUB AND AWAIT INSTRUCTIONS.

ALL TIMES  
PACIFIC DAYLIGHT SAVING

AFTER UNLOADING GUESTS AT ADMINISTRATION BUILDING, BUSES WILL EACH BE ASSIGNED AN ATTACHE. BUSES WILL PARK AT REAR OF CIRCLE TO TRANSPORT GUESTS TO GRANDSTAND. COLORS WILL NOT BE DISPLAYED UNTIL AFTER UNLOADING AT THE GRANDSTAND.

NOTE:— AFTER UNLOADING AT TERMINATION OF EACH ROUTE, BUSES ARE TO PROCEED TO START OF NEXT ROUTE AND AWAIT NEXT TIME OF DEPARTURE

| GOLD GROUP<br>-KEY- |                                   | EVENT<br>STARTS |
|---------------------|-----------------------------------|-----------------|
| →                   | → RIDE                            |                 |
| - - -               | - - - WALK                        |                 |
|                     | REGISTRATION                      | 9:30 A.M.       |
|                     | INTRODUCTORY SESSION (AUDITORIUM) | 10:00           |
|                     | PHOTOGRAPH (GRANDSTAND)           | 10:32           |
| 1                   | 16' WIND TUNNEL                   | 10:45           |
| 2                   | 7'x10' WIND TUNNEL                | 11:15           |
| 3                   | 12' WIND TUNNEL                   | 11:45           |
| 4                   | 1'x3' SUPERSONIC TUNNEL           | 12:15 P.M.      |
|                     | LUNCH                             | 12:45           |
| 5                   | FLIGHT RESEARCH                   | 2:15            |
| 6                   | 40'x80' WIND TUNNEL               | 2:45            |
| 7                   | LOW-DENSITY TUNNEL                | 3:15            |
| 8                   | 6'x6' SUPERSONIC TUNNEL           | 3:45            |
| 9                   | AIR INDUCTION (16' W.T. LAB.)     | 4:15            |
|                     | N.A.S. OFFICERS CLUB              | 4:45            |

| BUS ROUTE<br>-KEY- |            |                 |            |
|--------------------|------------|-----------------|------------|
| →                  |            | WITH PASSENGERS |            |
| - - -              |            | NO PASSENGERS   |            |
| ROUTE              | BUS STARTS | ROUTE           | BUS STARTS |
| A                  | 10:23 A.M. | F               | 2:40 P.M.  |
| B                  | 11:40      | G               | 3:40       |
| C                  | 12:10 P.M. | H               | 4:10       |
| D                  | 12:40      | I               | 4:40       |
| E                  | 2:10       |                 |            |





1948 INSPECTION

AMES AERONAUTICAL LABORATORY.

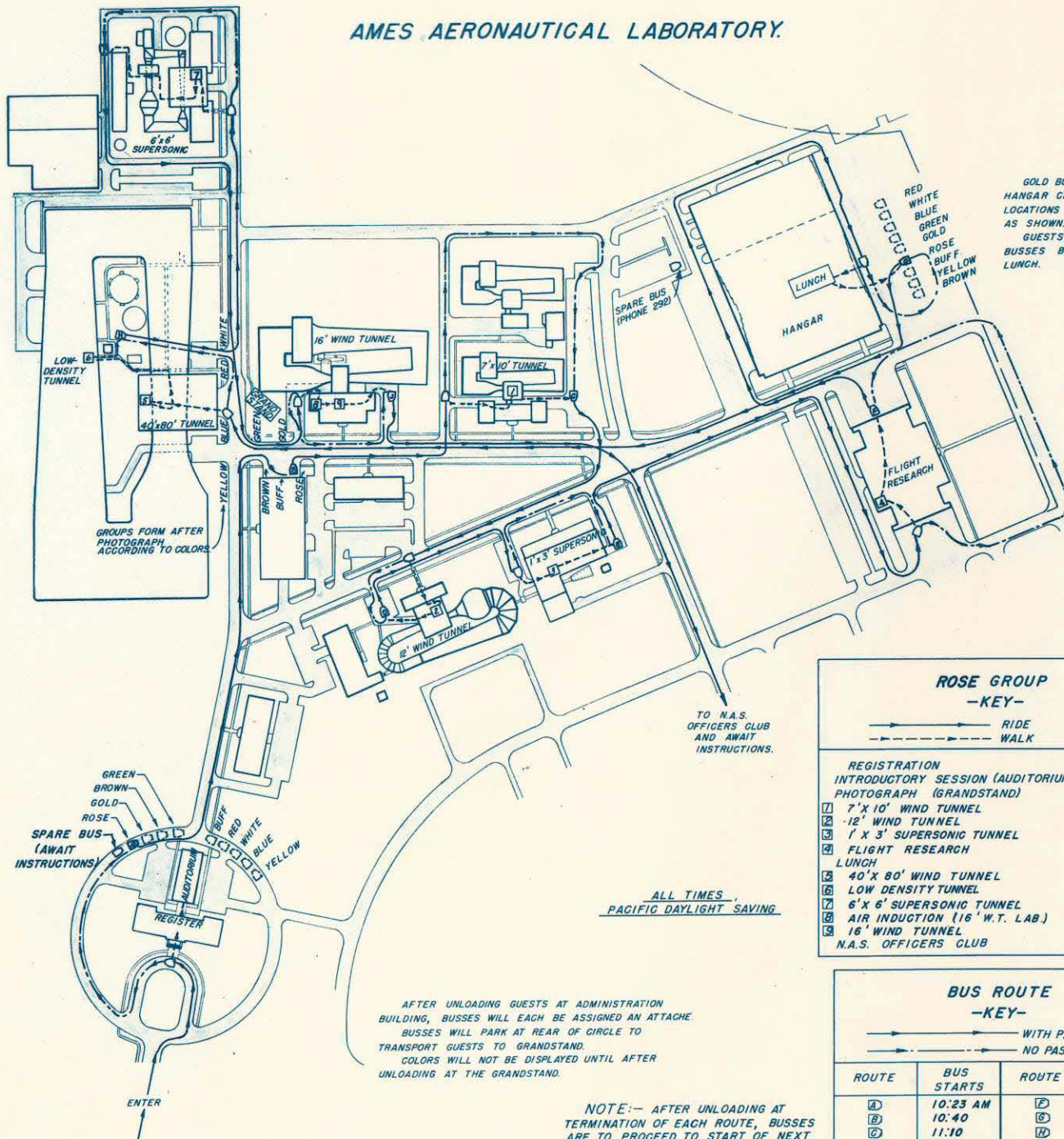

GOLD BUS PARKED OPPOSITE HANGAR CENTER. RELATIVE LOCATIONS OF OTHER BUSES AS SHOWN. GUESTS TO BE ABOARD BUSES BY 2:05 P.M. AFTER LUNCH.

GROUPS FORM AFTER PHOTOGRAPH ACCORDING TO COLORS

TO N.A.S. OFFICERS CLUB AND AWAIT INSTRUCTIONS.

ALL TIMES PACIFIC DAYLIGHT SAVING

AFTER UNLOADING GUESTS AT ADMINISTRATION BUILDING, BUSES WILL EACH BE ASSIGNED AN ATTACHE. BUSES WILL PARK AT REAR OF CIRCLE TO TRANSPORT GUESTS TO GRANDSTAND. COLORS WILL NOT BE DISPLAYED UNTIL AFTER UNLOADING AT THE GRANDSTAND.

NOTE:- AFTER UNLOADING AT TERMINATION OF EACH ROUTE, BUSES ARE TO PROCEED TO START OF NEXT ROUTE AND AWAIT NEXT TIME OF DEPARTURE.

**ROSE GROUP -KEY-**

→ RIDE  
- - - WALK

| EVENT                             | STARTS   |
|-----------------------------------|----------|
| REGISTRATION                      | 9:30 AM  |
| INTRODUCTORY SESSION (AUDITORIUM) | 10:00    |
| PHOTOGRAPH (GRANDSTAND)           | 10:32    |
| 1 7' X 10' WIND TUNNEL            | 10:45    |
| 2 12' WIND TUNNEL                 | 11:15    |
| 3 1' X 3' SUPERSONIC TUNNEL       | 11:45    |
| 4 FLIGHT RESEARCH                 | 12:15 PM |
| LUNCH                             |          |
| 5 40' X 80' WIND TUNNEL           | 2:15     |
| 6 LOW DENSITY TUNNEL              | 2:45     |
| 7 6' X 6' SUPERSONIC TUNNEL       | 3:15     |
| 8 AIR INDUCTION (16' W.T. LAB.)   | 3:45     |
| 9 16' WIND TUNNEL                 | 4:15     |
| N.A.S. OFFICERS CLUB              | 4:45     |

**BUS ROUTE -KEY-**

→ WITH PASSENGERS  
- - - NO PASSENGERS

| ROUTE | BUS STARTS | ROUTE | BUS STARTS |
|-------|------------|-------|------------|
| A     | 10:23 AM   | F     | 12:40      |
| B     | 10:40      | G     | 2:10       |
| C     | 11:10      | H     | 3:10       |
| D     | 11:40      | I     | 3:40       |
| E     | 12:10 PM   | J     | 4:40       |





1948 INSPECTION

AMES AERONAUTICAL LABORATORY

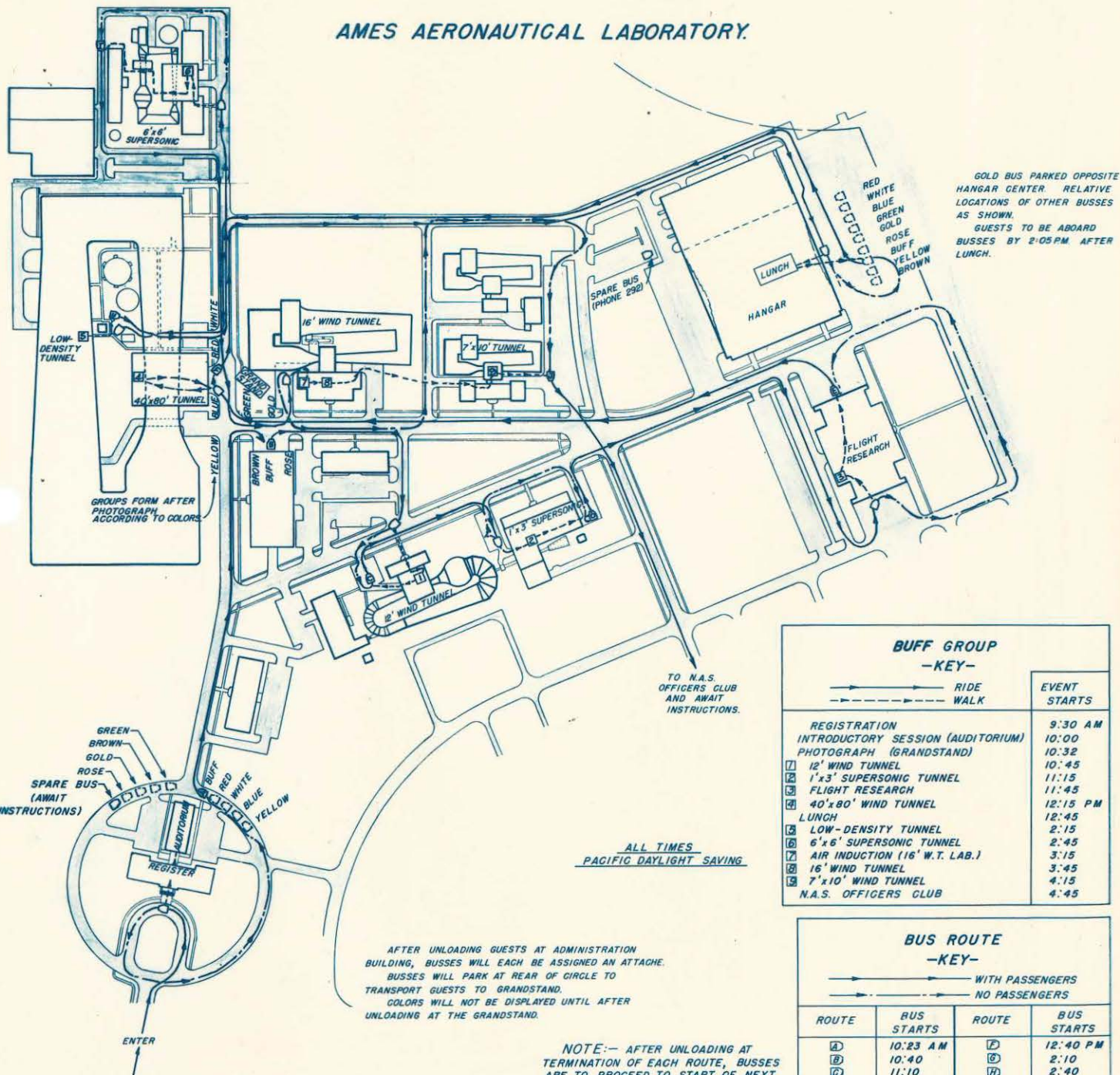

GOLD BUS PARKED OPPOSITE HANGAR CENTER. RELATIVE LOCATIONS OF OTHER BUSES AS SHOWN. GUESTS TO BE ABOARD BUSES BY 2:05 PM AFTER LUNCH.

TO N.A.S. OFFICERS CLUB AND AWAIT INSTRUCTIONS.

ALL TIMES PACIFIC DAYLIGHT SAVING

AFTER UNLOADING GUESTS AT ADMINISTRATION BUILDING, BUSES WILL EACH BE ASSIGNED AN ATTACHE. BUSES WILL PARK AT REAR OF CIRCLE TO TRANSPORT GUESTS TO GRANDSTAND. COLORS WILL NOT BE DISPLAYED UNTIL AFTER UNLOADING AT THE GRANDSTAND.

NOTE:— AFTER UNLOADING AT TERMINATION OF EACH ROUTE, BUSES ARE TO PROCEED TO START OF NEXT ROUTE AND AWAIT NEXT TIME OF DEPARTURE.

| BUFF GROUP<br>-KEY- |                                   | EVENT<br>STARTS |
|---------------------|-----------------------------------|-----------------|
| →                   | — RIDE                            |                 |
| - - -               | — WALK                            |                 |
|                     | REGISTRATION                      | 9:30 AM         |
|                     | INTRODUCTORY SESSION (AUDITORIUM) | 10:00           |
|                     | PHOTOGRAPH (GRANDSTAND)           | 10:32           |
| ①                   | 12' WIND TUNNEL                   | 10:45           |
| ②                   | 1'x3' SUPERSONIC TUNNEL           | 11:15           |
| ③                   | FLIGHT RESEARCH                   | 11:45           |
| ④                   | 40'x80' WIND TUNNEL               | 12:15 PM        |
|                     | LUNCH                             | 12:45           |
| ⑤                   | LOW-DENSITY TUNNEL                | 2:15            |
| ⑥                   | 6'x6' SUPERSONIC TUNNEL           | 2:45            |
| ⑦                   | AIR INDUCTION (16' W.T. LAB.)     | 3:15            |
| ⑧                   | 16' WIND TUNNEL                   | 3:45            |
| ⑨                   | 7'x10' WIND TUNNEL                | 4:15            |
|                     | N.A.S. OFFICERS CLUB              | 4:45            |

| BUS ROUTE<br>-KEY- |                   |       |            |
|--------------------|-------------------|-------|------------|
| →                  | — WITH PASSENGERS |       |            |
| →                  | — NO PASSENGERS   |       |            |
| ROUTE              | BUS STARTS        | ROUTE | BUS STARTS |
| A                  | 10:23 AM          | D     | 12:40 PM   |
| B                  | 10:40             | E     | 2:10       |
| C                  | 11:10             | F     | 2:40       |
| D                  | 11:40             | G     | 3:10       |
| E                  | 12:10 PM          | H     | 4:40       |





1948 INSPECTION

AMES AERONAUTICAL LABORATORY

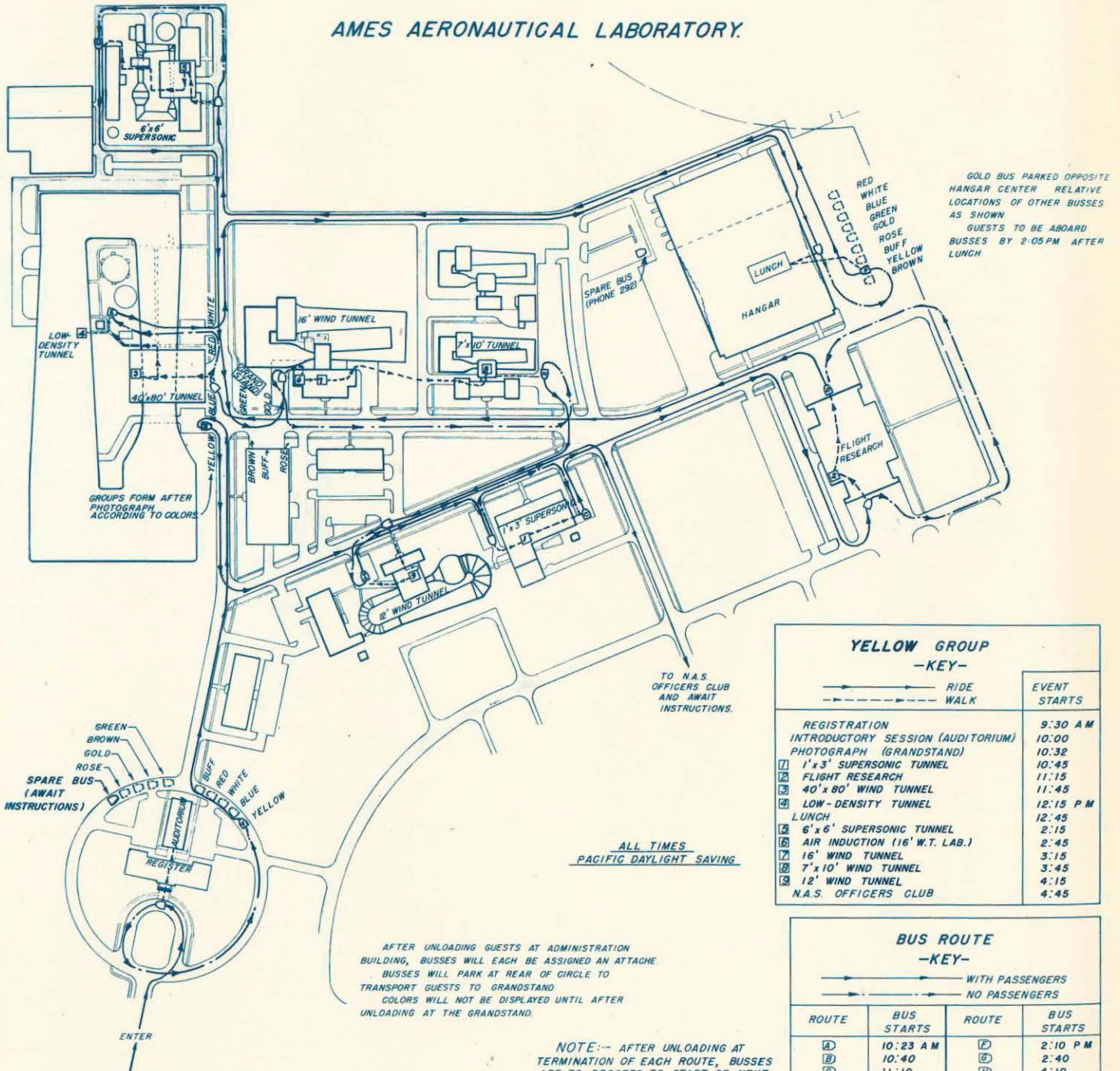

GOLD BUS PARKED OPPOSITE HANGAR CENTER RELATIVE LOCATIONS OF OTHER BUSES AS SHOWN  
GUESTS TO BE ABOARD BUSES BY 2:05 PM AFTER LUNCH

**YELLOW GROUP -KEY-**

|                                   | EVENT STARTS |
|-----------------------------------|--------------|
| REGISTRATION                      | 9:30 AM      |
| INTRODUCTORY SESSION (AUDITORIUM) | 10:00        |
| PHOTOGRAPH (GRANDSTAND)           | 10:32        |
| 1 1'x3' SUPERSONIC TUNNEL         | 10:45        |
| 2 FLIGHT RESEARCH                 | 11:15        |
| 3 40'x80' WIND TUNNEL             | 11:45        |
| 4 LOW-DENSITY TUNNEL              | 12:15 P M    |
| LUNCH                             | 12:45        |
| 5 6'x6' SUPERSONIC TUNNEL         | 2:15         |
| 6 AIR INDUCTION (16' W.T. LAB.)   | 2:45         |
| 7 16' WIND TUNNEL                 | 3:15         |
| 8 7'x10' WIND TUNNEL              | 3:45         |
| 9 12' WIND TUNNEL                 | 4:15         |
| N.A.S. OFFICERS CLUB              | 4:45         |

**BUS ROUTE -KEY-**

| WITH PASSENGERS |            | NO PASSENGERS |            |
|-----------------|------------|---------------|------------|
| ROUTE           | BUS STARTS | ROUTE         | BUS STARTS |
| A               | 10:23 AM   | D             | 2:10 PM    |
| B               | 10:40      | E             | 2:40       |
| C               | 11:10      | F             | 4:10       |
| D               | 11:40      | G             | 4:40       |
| E               | 12:40 PM   |               |            |

ALL TIMES PACIFIC DAYLIGHT SAVING

AFTER UNLOADING GUESTS AT ADMINISTRATION BUILDING, BUSES WILL EACH BE ASSIGNED AN ATTACHE. BUSES WILL PARK AT REAR OF CIRCLE TO TRANSPORT GUESTS TO GRANDSTAND. COLORS WILL NOT BE DISPLAYED UNTIL AFTER UNLOADING AT THE GRANDSTAND.

NOTE:- AFTER UNLOADING AT TERMINATION OF EACH ROUTE, BUSES ARE TO PROCEED TO START OF NEXT ROUTE AND AWAIT NEXT TIME OF DEPARTURE





1948 INSPECTION

AMES AERONAUTICAL LABORATORY.

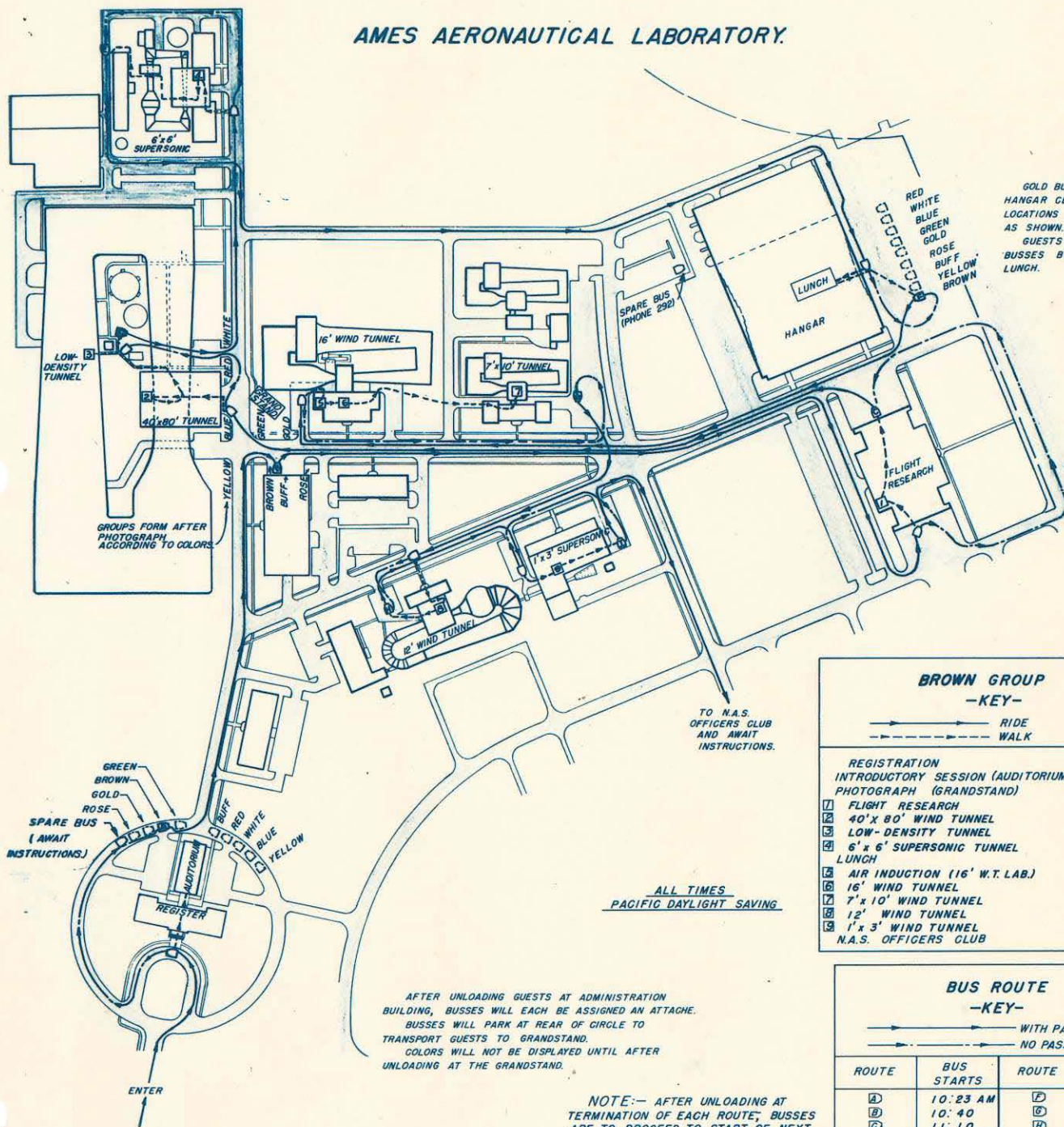

GOLD BUS PARKED OPPOSITE HANGAR CENTER. RELATIVE LOCATIONS OF OTHER BUSES AS SHOWN. GUESTS TO BE ABOARD BUSES BY 2:05 P.M. AFTER LUNCH.

GROUPS FORM AFTER PHOTOGRAPH ACCORDING TO COLORS.

TO N.A.S. OFFICERS CLUB AND AWAIT INSTRUCTIONS.

ALL TIMES PACIFIC DAYLIGHT SAVING.

AFTER UNLOADING GUESTS AT ADMINISTRATION BUILDING, BUSES WILL EACH BE ASSIGNED AN ATTACHE. BUSES WILL PARK AT REAR OF CIRCLE TO TRANSPORT GUESTS TO GRANDSTAND. COLORS WILL NOT BE DISPLAYED UNTIL AFTER UNLOADING AT THE GRANDSTAND.

NOTE:- AFTER UNLOADING AT TERMINATION OF EACH ROUTE, BUSES ARE TO PROCEED TO START OF NEXT ROUTE AND AWAIT NEXT TIME OF DEPARTURE.

**BROWN GROUP -KEY-**

→ RIDE  
- - - WALK

|                                   | EVENT STARTS |
|-----------------------------------|--------------|
| REGISTRATION                      | 9:30 AM      |
| INTRODUCTORY SESSION (AUDITORIUM) | 10:00        |
| PHOTOGRAPH (GRANDSTAND)           | 10:32        |
| ⑦ FLIGHT RESEARCH                 | 10:45        |
| ② 40'x 80' WIND TUNNEL            | 11:15        |
| ③ LOW-DENSITY TUNNEL              | 11:45        |
| ④ 6' x 6' SUPERSONIC TUNNEL       | 12:15 PM     |
| LUNCH                             | 12:45        |
| ⑤ AIR INDUCTION (16' W.T. LAB.)   | 2:15         |
| ⑥ 16' WIND TUNNEL                 | 2:45         |
| ⑦ 7' x 10' WIND TUNNEL            | 3:15         |
| ⑧ 12' WIND TUNNEL                 | 3:45         |
| ⑨ 1' x 3' WIND TUNNEL             | 4:15         |
| N.A.S. OFFICERS CLUB              | 4:45         |

**BUS ROUTE -KEY-**

→ WITH PASSENGERS  
- - - NO PASSENGERS

| ROUTE | BUS STARTS | ROUTE | BUS STARTS |
|-------|------------|-------|------------|
| A     | 10:23 AM   | D     | 2:10       |
| B     | 10:40      | E     | 3:40       |
| C     | 11:10      | F     | 4:10       |
| D     | 12:10 PM   | G     | 4:40       |
| E     | 12:40      |       |            |