

TESTING PROCEDURE

Be sure to read through these steps prior to testing and follow them accurately during testing!

STEP 1: The Test Facilitator should place the unassembled bolts, washers, and wing nuts in their containers as shown. An empty container for the hardware assembly should be placed above the other containers.



STEP 2: The Test Facilitator should set their countdown timer to 1 minute.

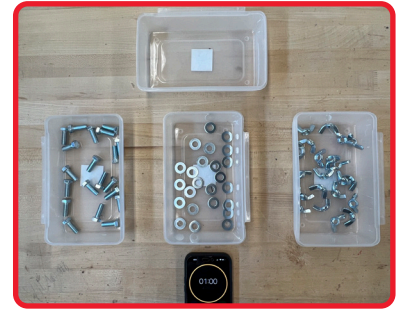

STEP 3: The Test Facilitator should say "Ready, set, go!" As soon as the Space Suit Engineer hears "go!" they should begin putting together the hardware assemblies.



STEP 4: Once a hardware assembly is completed and finger tight, the Space Suit Engineer should place the assembly in the container above the washer, wing nut, and bolt containers.



STEP 5: When the timer gets to 10 seconds, the Space Suit Engineer should count down the final 10 seconds: "10, 9, 8, 7, 6, 5, 4, 3, 2, 1" and then say, "Stop!"



STEP 6: When the Space Suit Engineer hears the word "stop", they should immediately stop assembling hardware. Incomplete assemblies do not count toward the total!



Follow these final steps!

- Count the number of washers, bolts, and wing nuts that were assembled by the Space Suit Engineer.
- Record your data in the Test Data Table in your Spacesuit Glove Dexterity Data Recording Sheet.
- Complete the rest of the Spacesuit Glove Dexterity Data Recording Sheet.